

Greene's Addition TO THE City of Seattle.

SCALE 200 FEET TO ONE INCH

WHITWORTH THOMSON
ENGINEERS & SURVEYORS
SEATTLE W.T.

-LEGEND-

This Greene Addition to the City of Seattle is situated on and embraces the following described three (3) tracts of lands to-wit: 1st. A tract of land owned by George Kinnear. Said tract beginning at a point 1646 feet North of the 1/4 section corner on the line between sections 80th & 29 of 1st P. 25 N. of T. 4 E. W. 11. King Co. W. T. and running thence: North 32.4 feet, thence West to the shore of Lake Union, thence in a southerly direction following the meanders of the shore of Lake Union to a point one West of the beginning point of said tract, thence East 1336 feet to the place of beginning 2nd A tract of land owned by Roger B. Greene which said tract begins at a point which is 1970 feet North of the said 1/4 section corner on the line between sections 20th & 29 which said point is also the Northeast corner of the 1st aforesaid tract owned by George Kinnear, and running thence North 466 feet; thence West 1466 feet to the shore of Lake Union; thence in a southerly direction along the meanders of the shore of Lake Union to the North West corner of the 1st aforesaid tract owned by George Kinnear, thence East along the North boundary line of the said Kinnear tract to the place of beginning; and 3rd A tract of land owned by D. J. Denny commencing at a point 2436 ft North of the said 1/4 section corner on the line between sections 20th & 29 and which said point is the Northeast corner of the said Greene tract, thence North 1126 feet, thence West 745 feet to the East boundary line of a tract owned to Charles Kitch by D. J. Denny & wife July 18th 1878th recorded in vol 16 of 2003 page 118; thence South along the East boundary of said tract 305 feet to the southeast corner of said tract; thence West to the shore of Lake Union thence in a southerly direction following the meanders of the shore of Lake Union to the North West corner of the Greene tract; thence East along the North boundary line of the Greene tract to the place of beginning 1st The initial point of this plat is the South East corner of block 1 which said corner is 30 feet West of and 30 feet North of the South East corner of tract No 1 on the Kinnear tract. The lots in blocks 1, 2, 3, 4, 7, 8, 9, 10, 11, 12, 13, and 14 are 60 by 110 feet. The lots in blocks 5th & 15 are 60 by 120 feet. The lots in blocks 6th & 17 are 60 feet wide and extend westward to deep water in Lake Union. Vicks, Lemia and Emma Streets are 30 feet wide. Orange street is 75 feet wide Red street is 40 feet wide and the remaining streets are 60 feet wide. Alleys are 20 feet wide. Fractional lots are as shown on plat.

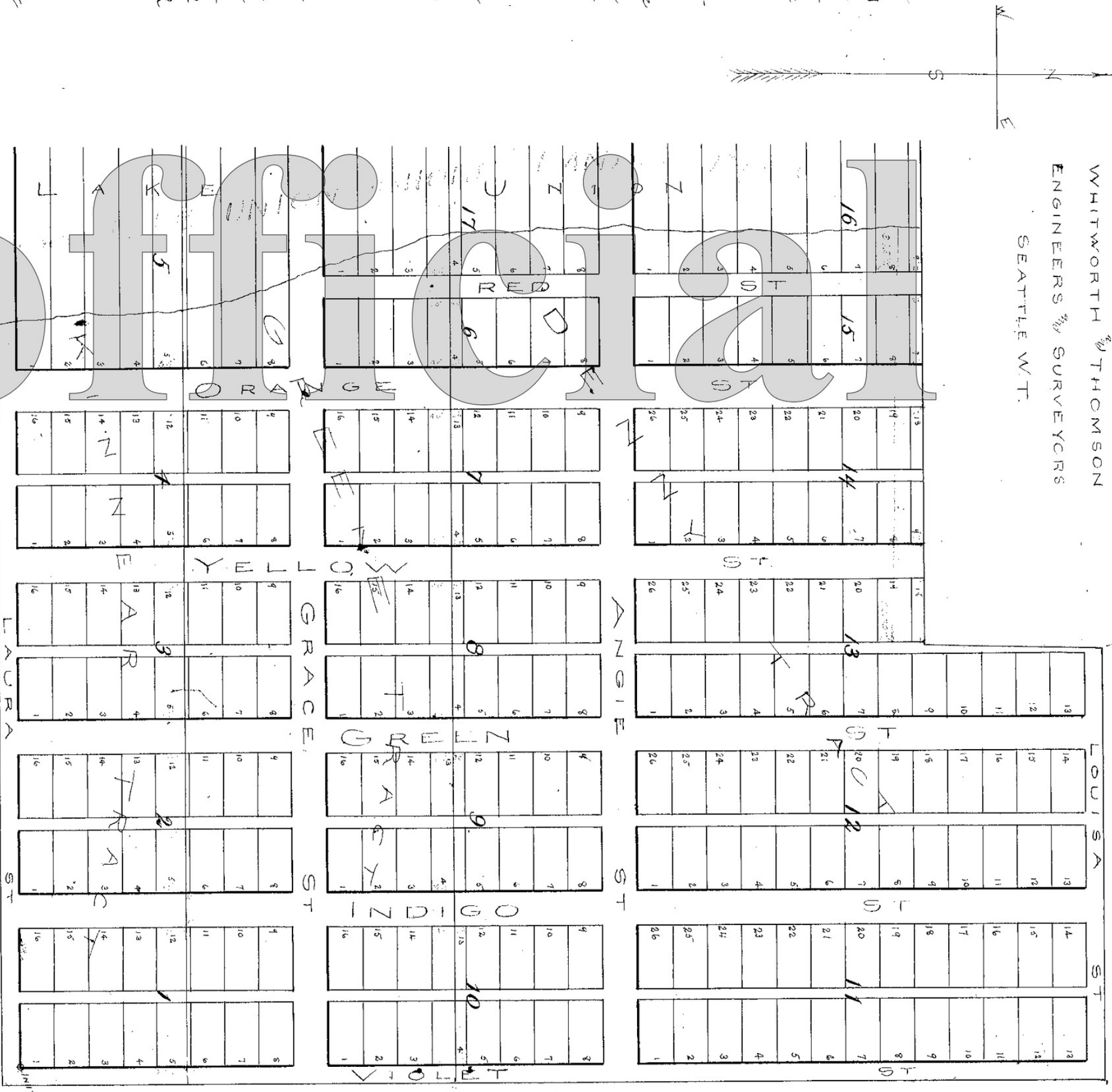

-CERTIFICATE-

We George Kinnear, Angie E. Kinnear his wife and Roger B. Greene Grace W. Greene his wife David J. Denny Emma Denny his wife the owners in fee simple of the tracts of land embraced in this plat of Greene Addition to the City of Seattle hereby jointly & severally acknowledge & certify that we have by deed one of us voluntarily of his or her own free will has laid out and platted the same into lots, blocks streets and alleys in accordance with the foregoing plat

Witness our hands and seals this 12th day of March A. D. 1887

In presence of
 E. J. Chinn
 Notary Public for King County
 of Washington
 at Seattle
 W. H. Denny
 Notary Public for King County
 of Washington
 at Seattle
 F. H. Whitworth
 Notary Public for King County
 of Washington
 at Seattle

-ACKNOWLEDGEMENT-

Territory of Washington
 County of King

Personally appeared before me a Notary Public in and for King County Washington Territory George Kinnear, Angie E. Kinnear, his wife and Roger B. Greene, Grace W. Greene, Lemia and Emma Denny, his wife and David J. Denny, Emma Denny, his wife having fully made known to them the contents of this instrument and having examined the said Angie E. Kinnear and the said Grace W. Greene and the said Emma Denny separate and apart from their said husbands, they did each for himself and herself acknowledge this plat to be their free and voluntary act, done without the fear of any one and for the purposes therein mentioned

In witness whereof I have hereunto set my hand and official seal this 12th day of March A. D. 1887

F. H. Whitworth
 Notary Public

Approved by the Mayor of the Common Council of the City of Seattle on the 15th day of April A. D. 1887

W. H. Denny
 Mayor

W. H. Forrest
 Clerk

Approved by the Mayor of the City of Seattle on the 15th day of April A. D. 1887

-15246-

Filed for Record at the request of Ho-ger B. Greene April 18th A. D. 1887 at 1 min. past 2 P. M. recorded in Vol. 2 of plat page 73 Records of King County, W. T.

W. H. Forrest
 Clerk