

SUPPLEMENTARY

ADDITION TO THE

A. M. Reynolds C.E.
Scale 150 ft = 1 inch.



City of Seattle King Co. Washington.

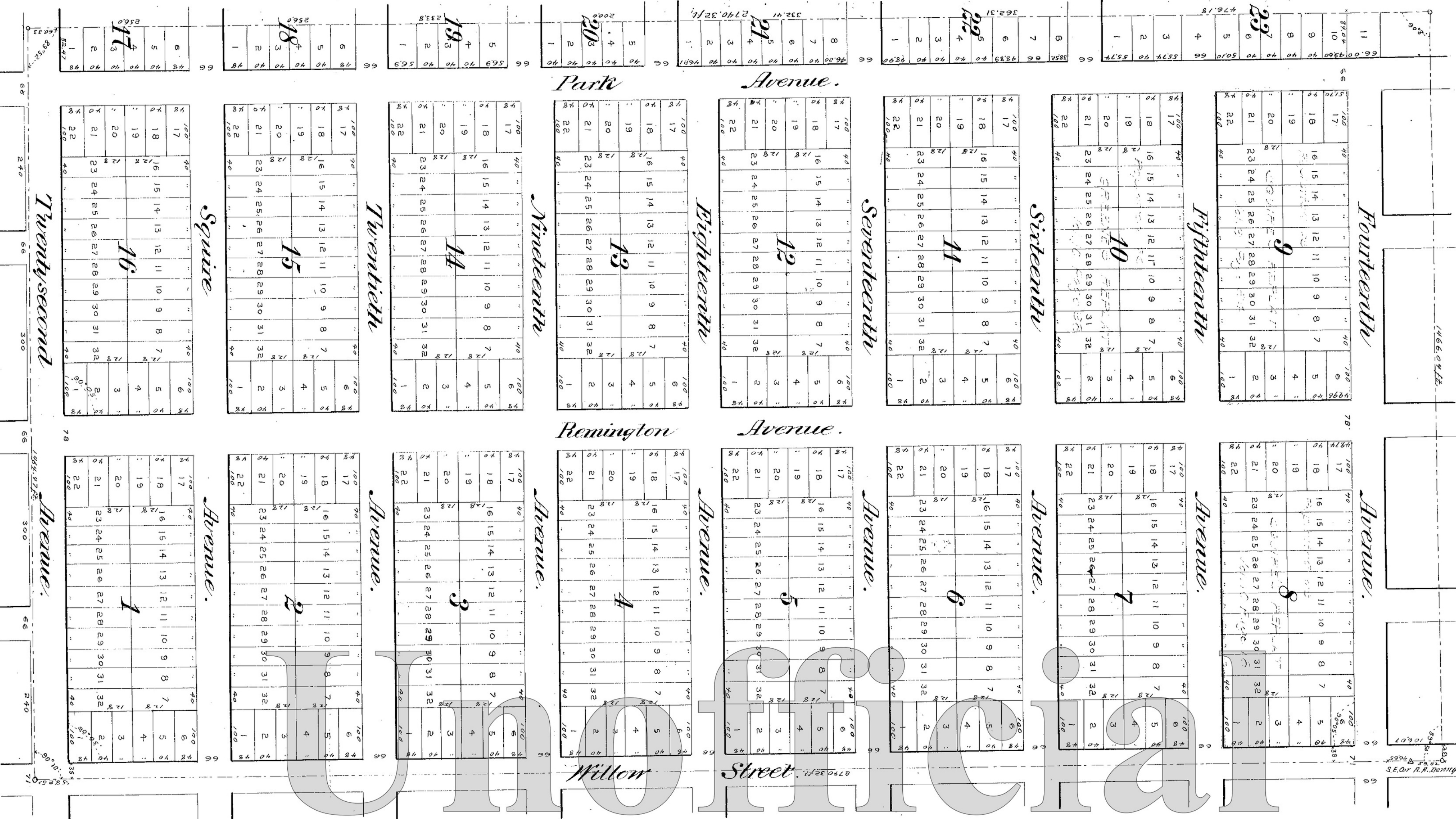

Description.

This Plat of Squire Park (Addition to the City of Seattle, King Co. Washington) is embraced within the following described boundaries: Beginning at a point 47.15 feet North of the S.E. Corner of the C. H. Boren Donation Plats, running thence West a distance of 2740.32 feet, thence North a distance of 1466.04 feet, thence East a distance of 2740.32 feet, thence South a distance of 1464.47 feet to the point of beginning. The initial point of this plat is the S.E. Corner of this tract. The widths of Streets and Avenues are as shown on this plat.

Dedication.

Then all men by these Presents, that we W. C. Squire and Ida H. Squire, his wife, and each of us, owners in fee simple of the above described plat of the Squire Park (Addition to the City of Seattle, King Co. Washington) do hereby declare this plat and dedicate to the uses of the Public, forever all the Avenues and streets platted therein.

We witness whereof we have hereunto set our hands and affixed our seals, this Eleventh Day of November A. D. Eighteen hundred and ninety (1890)

In presence of
 Frank H. Westling } Watson C. Squire. (ss.)
 Ida H. Squire } Ida H. Squire. (ss.)
 Alex. M. Reynolds }
 A. M. Reynolds

Acknowledgment.

State of Washington }
 County of King } ss.

I, Frank H. Westling a Notary Public, in and for the State of Washington, duly commissioned and sworn, do hereby certify that on this Eleventh day of November A. D. Eighteen hundred and ninety (1890) personally appeared, named and ninety (1890) personally appeared, before me, W. C. Squire & Ida H. Squire, his wife, the wife of W. C. Squire & Ida H. Squire, his wife, and we encountered this plat of the Squire Park (Addition to the City of Seattle, King Co. Washington) and acknowledged that they signed and sealed the same as their free and voluntary act and deed for the uses and purposes herein mentioned.

And the said Ida H. Squire, wife of said W. C. Squire upon examination by me separate and apart from her said husband, when the contents of said plat were by me fully apprised of her rights and she was by me fully apprised of her rights and the effect of signing the above plat, did, freely and voluntarily separate and apart from her said husband, acknowledge the same, acknowledging that she did voluntarily from her free will and without fear of or coercion from her husband, execute the same as her free and voluntary act and deed for the uses and purposes therein mentioned.
 Witness my hand and official Seal the day and year in this certificate first above written,
 Frank H. Westling,
 Notary Public in and for the State of Washington, Residing at Seattle.



Approved by me this the sixth day of December, 1890, Harry White, Mayor.

Examined & approved, Albro Gardner City Eng'r.

I have examined the Dedication & Acknowledgment of this Plat & find the same conform to the provisions of law. C. Jacobs, Corporation Counsel, Pr. Wm.

85181.

Filed for Record at Request of
 Howard P. Justice,
 at 409 1/2 Ave. 2nd North, Seattle, Wm.
 and recorded in Vol. III
 of Plats, page 6.
 Records of King County, Wash.

Attest: My Commission Expires
 Mt. Abbotsted by City Clerk
 King City Seal attached
 Co. Auction