

Terry's Second Addition

TO THE TOWN OF SEATTLE.

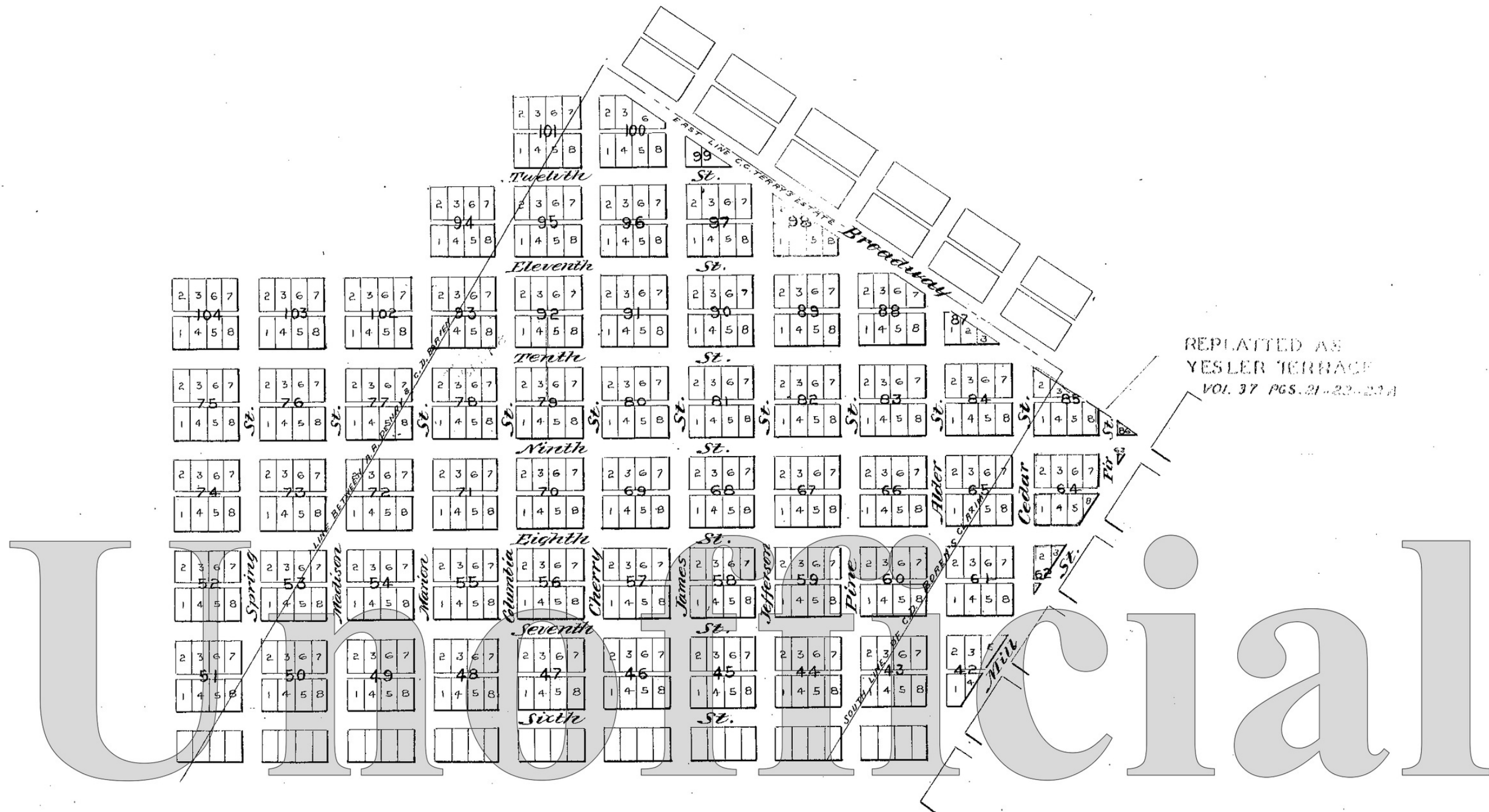

Being on the West half of C. D. Borer's Donation Claim including also Fractional parts of A. A. Denny & H. L. Yesler's Donation Claims in Sec 5 of Town 24 N. R. 4 E. & Sec 32 of Town 25 N. R. 4 E.

Blocks from 6th to 9th Street previously recorded except the fractional blocks No 42, 43, 51, 53, 60, 61, 62, 63, 64, 65 & 72, belonging to H. L. Yesler and A. A. Denny, since the making of this plat, Blocks No 52, 73, 74, 75 & 76 have been placed on Record by A. A. Denny as an extension of the First Addition, Broadway 80 ft. wide, other Streets 66 ft. wide Alleys 16 ft. Lots not fractional 60 by 120 ft. Streets run N 32° W and 58° E, excepting Mill Street and Broadway, Magnetic Variation 21° 45' East.

Franklin Matthias }
Erasmus M. Smithers } Executors of the Estate of C. C. Terry deceased,
A. H. Denny, Henry L. Yesler.

Territory of Washington }
County of King }

On this third day of December A. D. 1872, before me A. Mackintosh a Notary Public, personally came Franklin Matthias, Erasmus M. Smithers, Henry L. Yesler and A. A. Denny to me known to be the individuals who executed the within Town Plat, and whose names are subscribed thereto, the first two as executors of the last will and testament of Charles C. Terry deceased, the other two in their individual capacity, and acknowledged that they and each of them executed the same for the purposes therein mentioned and described.

In witness whereof I have hereunto set my hand and affixed my official seal the day and year first above written,
A. Mackintosh Notary Public W. T. Seal

Filed for Record Dec. 5th 1872 at 11.30 o'clock A. M.

D. T. Wheeler

Re-recorded or Transferred by S. C. Harris, Draftsman, Feb'y 16th 1875.