

# Ladd's Addition

TO THE  
City of Seattle.

**Explanation**  
This Ladd's Addition to the City of Seattle, comprises all of Lot 2, Sec. 15 & Lots 1, 2 & 3 Sec. 22 T<sub>1</sub> P<sub>2</sub> R<sub>3</sub> East W.M. The initial point of this plat is the S.E. cor. of Lot 1 of Block 1 which is 30 feet North and 30 feet West of the S.E. cor. of said Lot 3 Sec. 22 T<sub>1</sub> P<sub>2</sub> R<sub>3</sub> E. Full lots in blocks 1 to 59 inclusive are 50 by 107 feet, all other full lots are 50 x 100 feet and fractional or irregular lots, blocks and parcels are as shown on the plat. All Streets and Avenues are 60 feet wide except marginal streets are as shown on the plat. Alleys are 20 feet wide each.

**Dedication**  
Know all men presents, that I Geo. B. Kittinger owner in fee simple of the land hereby embraced in "Ladd's Addition to the City of Seattle" hereby declare this plat and hereby dedicate to the use of the public forever all the streets, alleys and avenues platted thereon.

In Witness Whereof I have hereunto set my hand and seal this 25th day of August A. D. 1886.

In presence of  
J. C. Primmer  
O. P. Anderson

Geo. B. Kittinger (Seal)

**Acknowledgement**  
Territory of Washington }  
County of King }

On this 25th day of August A. D. 1886 before me a Notary Public in and for Washington Territory appeared Geo. B. Kittinger (unmarried) proprietor of "Ladd's Addition to the City of Seattle" to me well known to be the person who executed this plat, and acknowledged that he executed the same freely and voluntarily for the uses and purposes therein mentioned.

Witness my hand and official seal this 25th day of August A. D. 1886.

O. P. Anderson  
Notary Public in and for Washington Territory

Scale 400 feet to an inch

No. 10410  
Filed for record at the request of  
Geo. B. Kittinger  
August 25th A. D. 1886.  
At 40 min past 2 p.m. and  
recorded in Vol. 2 of plats at  
page 59

J. Harris  
County Auditor

ELLIOTT BAY

Surveyed by Whitworth & Thomson  
Civil Engineers

Plotted by O. P. Anderson  
Draftsman

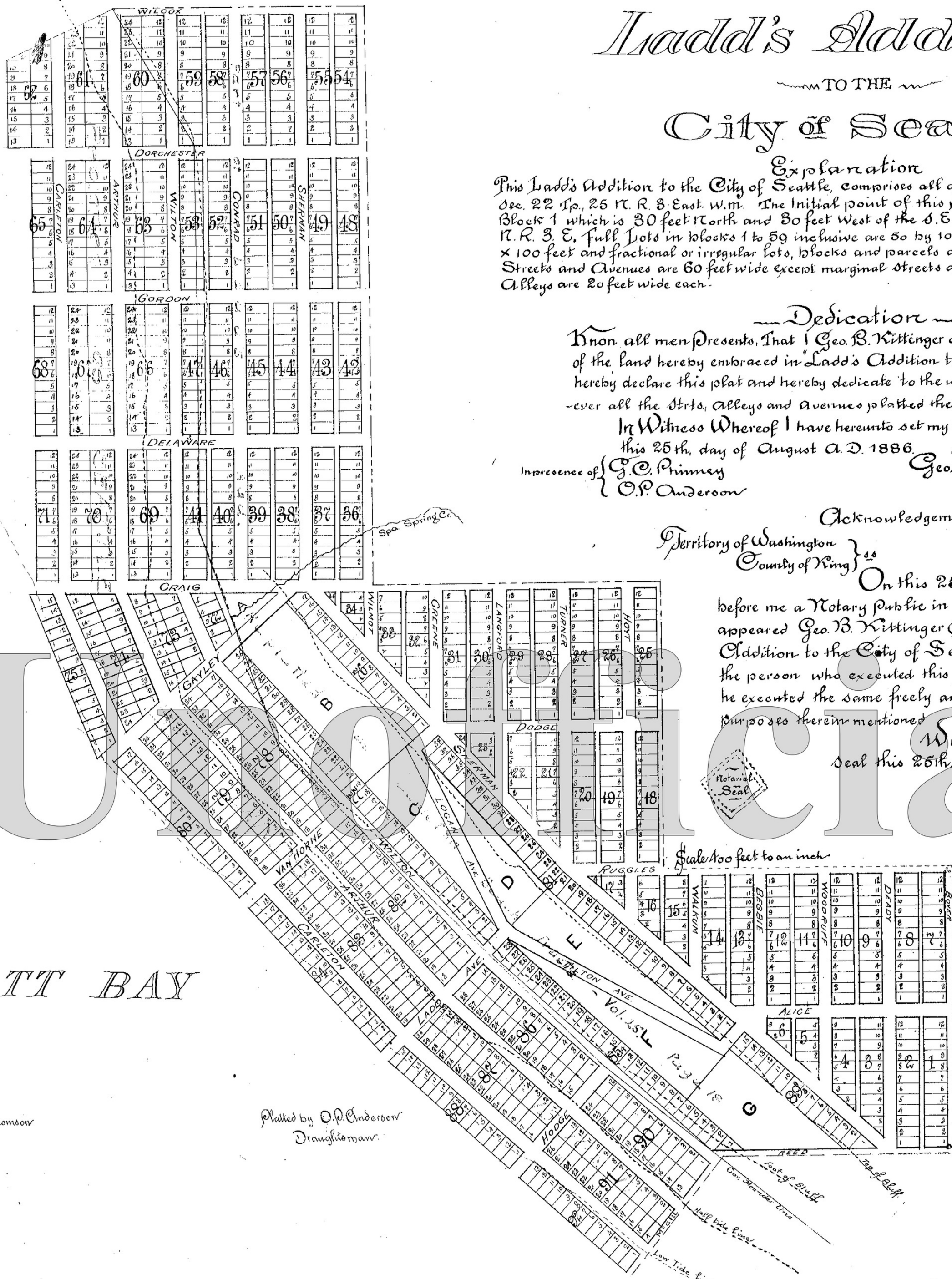

INITIAL POINT  
S. E. Cor. Lot 3 Sec. 22 T<sub>1</sub> P<sub>2</sub> R<sub>3</sub> E.